

WEST SUSSEX COUNTY COUNCIL  
((ADUR DISTRICT) (PARKING PLACES & TRAFFIC REGULATION)  
(CONSOLIDATION) ORDER 2009)  
(SHOREHAM/SOUTHWICK MINOR AMENDMENT) ORDER 2014

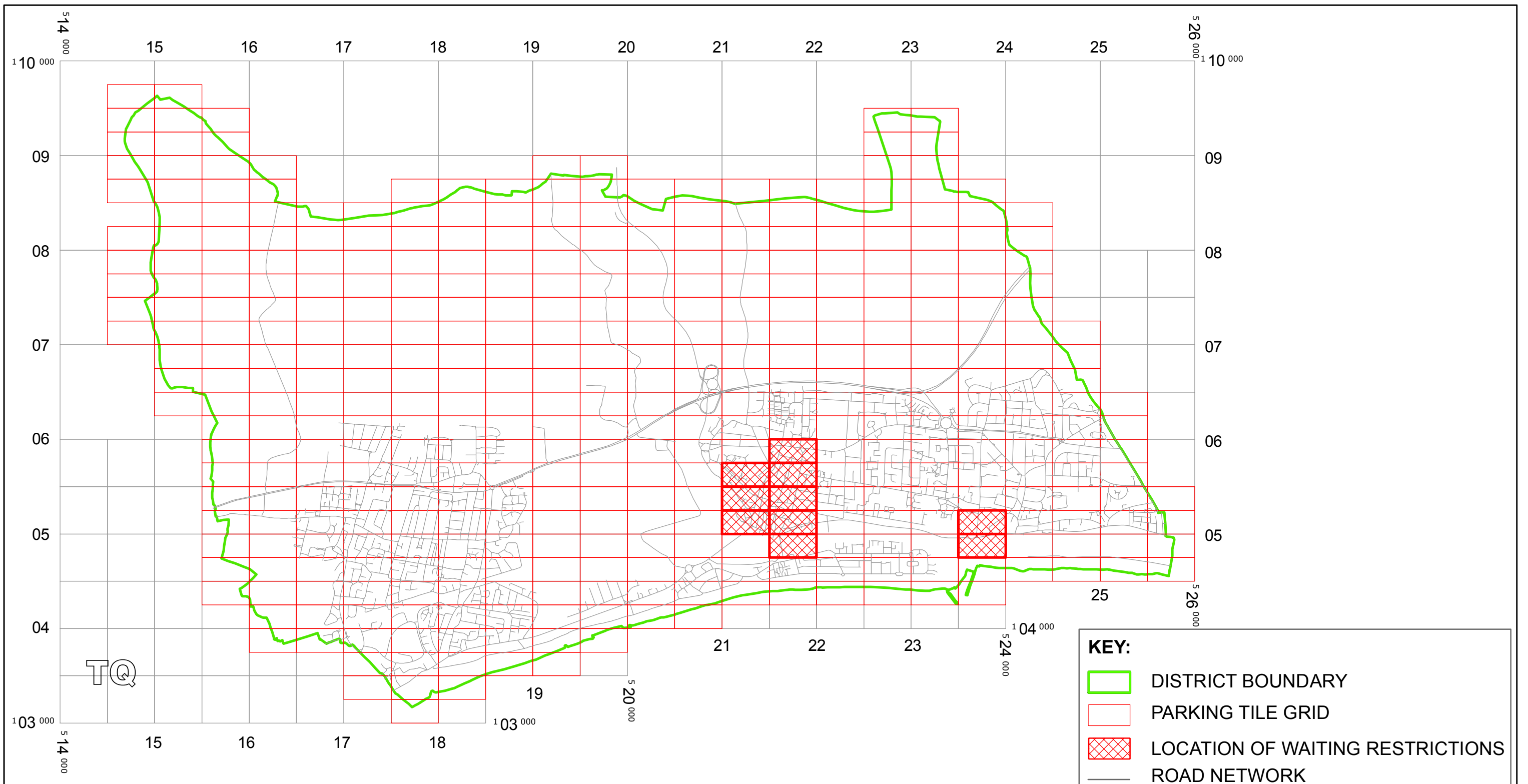

West Sussex County Council  
Infrastructure  
The Grange  
Tower Street  
Chichester  
West Sussex  
PO19 1RH

WEST SUSSEX COUNTY COUNCIL  
((ADUR DISTRICT) (PARKING PLACES & TRAFFIC REGULATION) (CONSOLIDATION) ORDER 2009)  
(SHOREHAM/SOUTHWICK MINOR AMENDMENT) ORDER 2014

#### LOCATION OF WAITING RESTRICTIONS

Reproduced from or based upon 2010 Ordnance Survey mapping with permission of the Controller of HMSO (c)  
Crown Copyright reserved. Unauthorised reproduction infringes Crown copyright and may lead to prosecution or  
civil proceedings West Sussex County Council Licence No. 100023447





SCALE: 1:40 000  
DATE: 01/05/2014

Key for Waiting Restrictions

All areas over which the provision of the orders apply are defined by the shaded areas as shown on the following plans plus a contiguous area not indicated on the plans of verge and/or footway between the carriageway edge and the highway boundary. The plans in this schedule are based upon grid references of the Ordnance Survey National Grid defined by the OSGB 36 triangulation.

Prohibition of waiting at any time

100		z_circle	No waiting, loading and unloading at any time
101		check	No waiting at any time

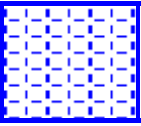
107		pat020	No waiting 8.00am-6.00pm Mon–Sat
-----	---	--------	----------------------------------

Prohibition of loading

228		usgs717	No waiting at any time, No loading and unloading 10.00am-5.00pm any day (2)
229		shd47	No waiting at any time, No loading and unloading 10.00am-6.00pm Mon-Sat (5)

Free Limited Waiting

713		pat063	Waiting limited to 2hrs No return within 2hrs 8.00am-6.00pm any day
716		shd62	Waiting limited to 1hr No return within 1hr 8.00am-6.00pm Mon–Sat

Specified Vehicles

830		check	Disabled persons vehicles at any time
844		usgs721	No stopping at any time except taxis
845		usgs602	No waiting at any time except taxis
863		usgs721	Parking places at any time

Clearways

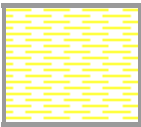
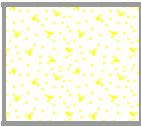
1104		usgs620	Bus stop clearway 7.00am-7.00pm any day
1105		usgs723	School Keep Clear No stopping 8.00am-6.00pm any day

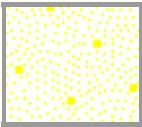
1113		pat055	Bus stop clearway No stopping except buses 8.00am-6.00pm Mon-Sat
------	---	--------	--

**WEST SUSSEX COUNTY COUNCIL**  
**((ADUR DISTRICT) (PARKING PLACES & TRAFFIC REGULATION)**  
**(CONSOLIDATION) ORDER 2009)**

**(SHOREHAM-BY-SEA: VARIOUS ROADS MINOR AMENDMENT)**  
**ORDER 2014**

West Sussex County Council in exercise of their powers under Sections 1 (1) 2 (1) and (2), 4 (2), 45, 46, 49 and 53 and Part IV of Schedule 9 of the Road Traffic Regulation Act 1984 ("the Act") as amended and of all other enabling powers and after consultation with the Chief Officer of Police in accordance with Part III of Schedule 9 to the Act hereby make the following Order:-

1. This Order shall come into operation on the First day of May 2014 and may be cited as "West Sussex County Council ((Adur District) (Parking Places & Traffic Regulation) (Consolidation) Order 2009) (Shoreham-by-Sea: Various Roads Minor Amendment) Order 2014".
2. The "West Sussex County Council (Adur District) (Parking Places & Traffic Regulation) (Consolidation) Order 2009" is hereby amended by the replacement of the plans specified in the First Schedule to this Order, with the plans specified in the Second Schedule, attached hereto.

**FIRST SCHEDULE**  
**Plans to be Replaced**

TQ2104NEN (Issue Number 2)  
TQ2105NEN (Issue Number 1)  
TQ2105NES (Issue Number 2)  
TQ2105NWS (Issue Number 1)  
TQ2105SEN (Issue Number 3)  
TQ2105SES (Issue Number 4)  
TQ2105SWN (Issue Number 2)  
TQ2105SWS (Issue Number 2)  
TQ2304NEN (Issue Number 1)  
TQ2305SES (Issue Number 1)

**SECOND SCHEDULE**  
**Replacement Plans**

TQ2104NEN (Issue Number 3)  
TQ2105NEN (Issue Number 2)  
TQ2105NES (Issue Number 3)  
TQ2105NWS (Issue Number 2)  
TQ2105SEN (Issue Number 4)  
TQ2105SES (Issue Number 5)  
TQ2105SWN (Issue Number 3)  
TQ2105SWS (Issue Number 3)  
TQ2304NEN (Issue Number 2)  
TQ2305SES (Issue Number 2)

)
)
)
)
)
)
)
)
)
)

Authorized Signatory  
ADR8005-MM



04/08 DELEGATED AUTHORITY



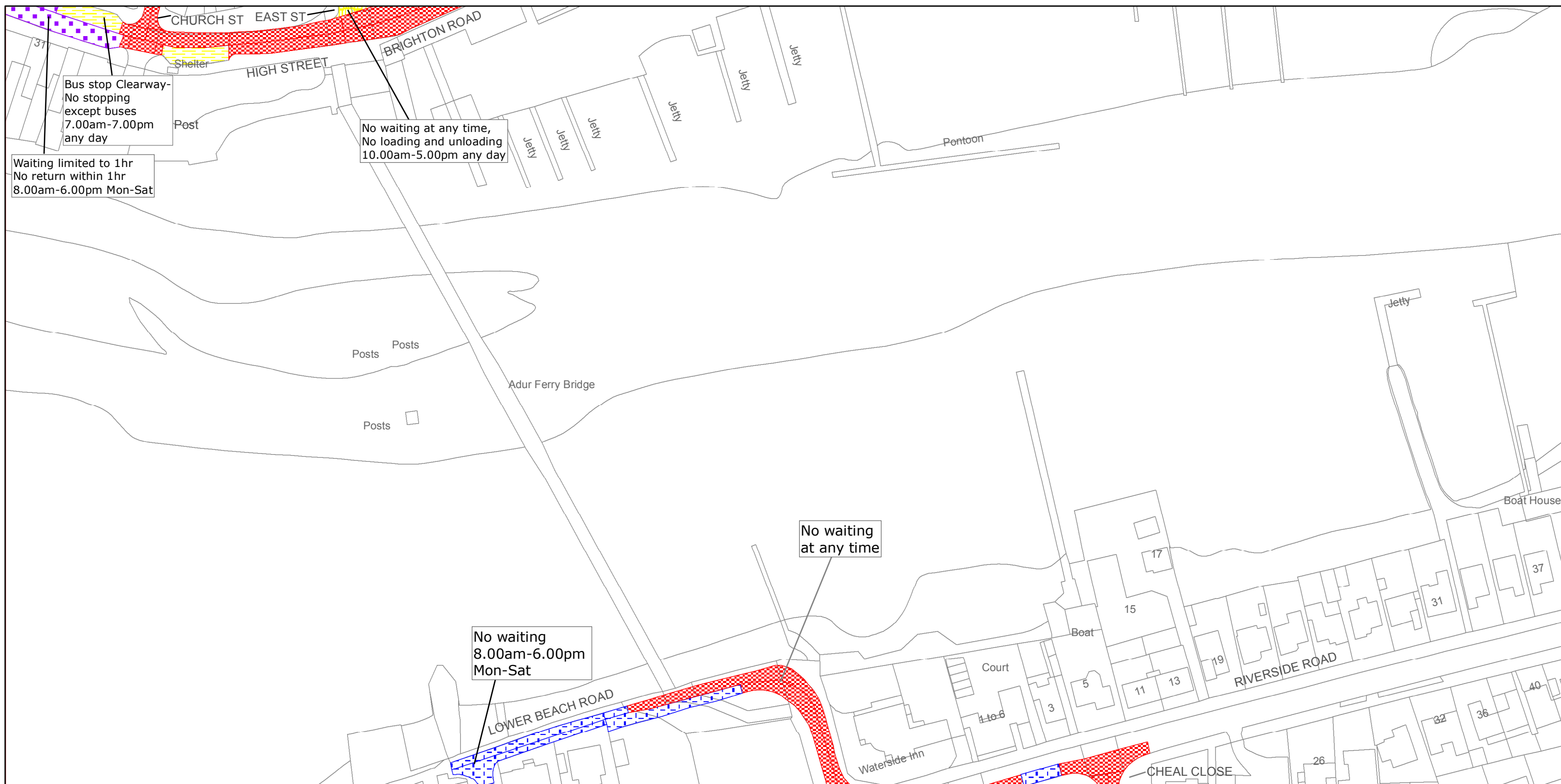

West Sussex County Council  
Highways & Transport  
The Grange  
Tower Street  
Chichester  
West Sussex  
PO19 1RH

ADUR DISTRICT: SHOREHAM/SOUTHWICK  
WAITING RESTRICTIONS

Reproduced from or based upon 2010 Ordnance Survey mapping with permission of the Controller of HMSO (c) Crown Copyright reserved.  
Unauthorised reproduction infringes Crown copyright and may lead to prosecution or civil proceedings West Sussex County Council Licence No. 100018485

TILE REF NO:  
TQ2104NEN

SHEET ISSUE NO 3  
SHEET ACTIVE FROM - 01/05/2014



SCALE:  
1:1250  
at A3 size

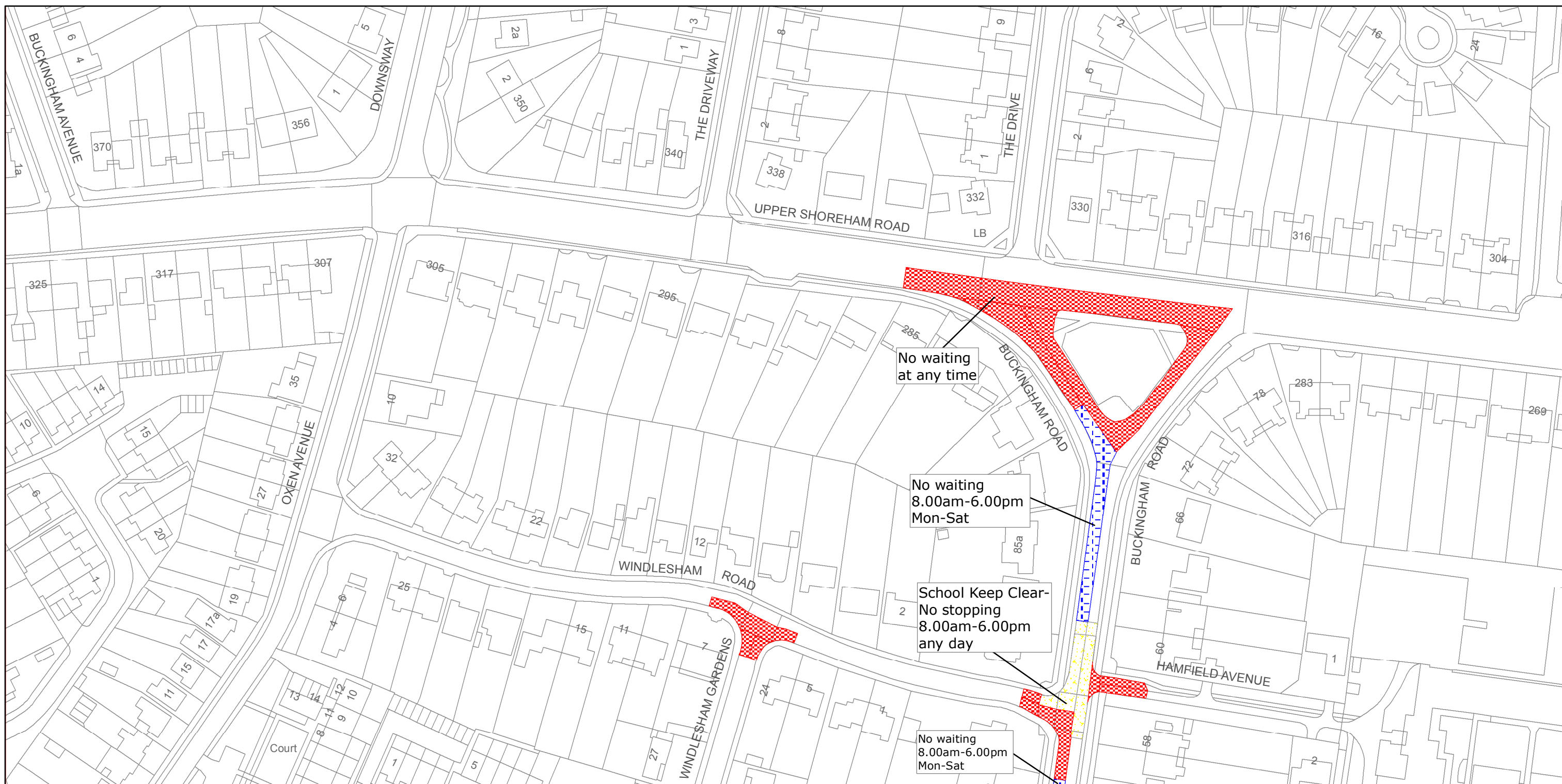

West Sussex County Council  
Highways & Transport  
The Grange  
Tower Street  
Chichester  
West Sussex  
PO19 1RH

ADUR DISTRICT: SHOREHAM/SOUTHWICK  
WAITING RESTRICTIONS

Reproduced from or based upon 2010 Ordnance Survey mapping with permission of the Controller of HMSO (c) Crown Copyright reserved.  
Unauthorised reproduction infringes Crown copyright and may lead to prosecution or civil proceedings West Sussex County Council Licence No. 100018485

TILE REF NO:  
TQ2105NEN

SHEET ISSUE NO 2  
SHEET ACTIVE FROM - 01/05/2014



SCALE:  
1:1250  
at A3 size



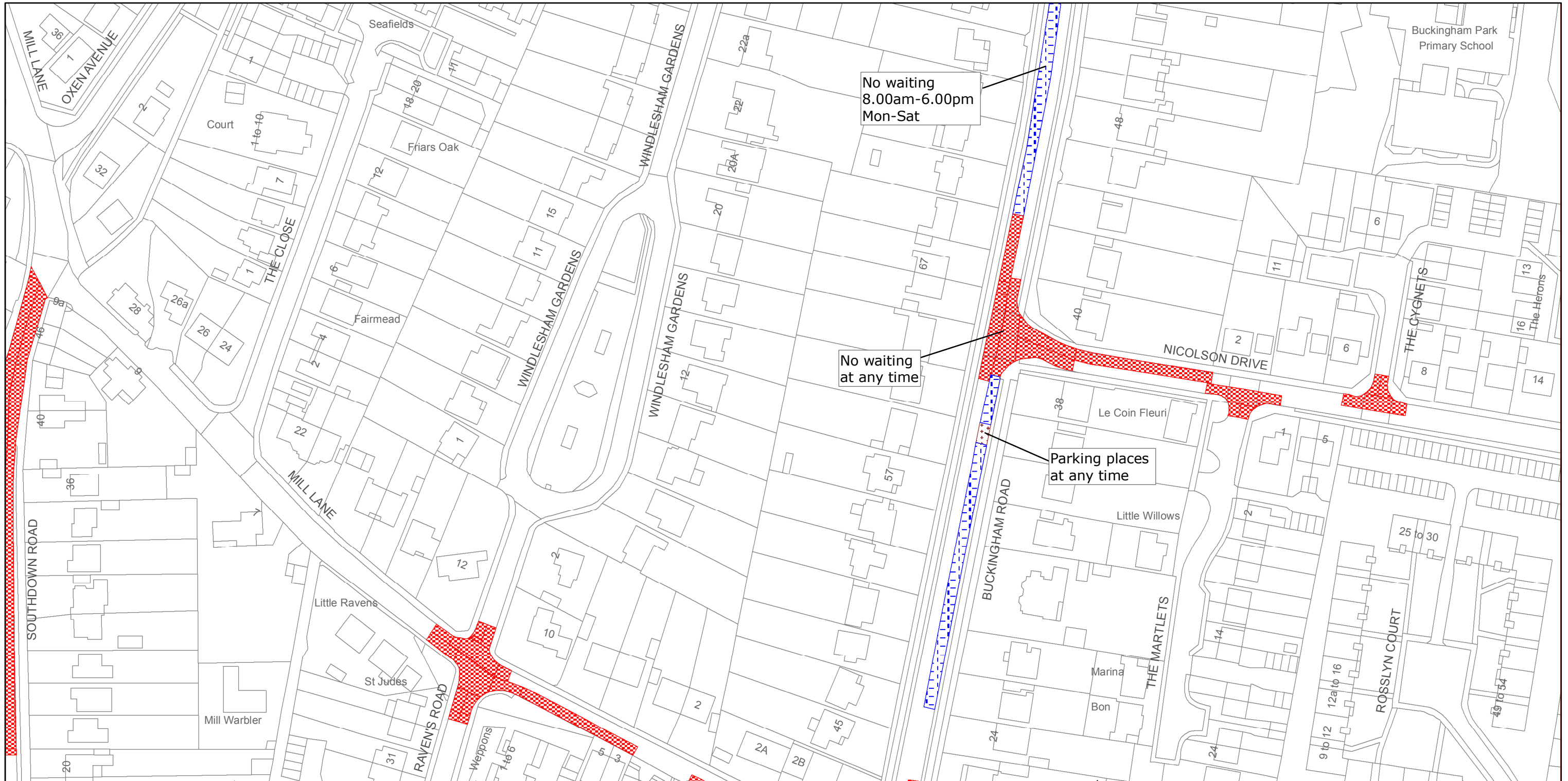

West Sussex County Council  
Highways & Transport  
The Grange  
Tower Street  
Chichester  
West Sussex  
PO19 1RH

ADUR DISTRICT: SHOREHAM/SOUTHWICK  
WAITING RESTRICTIONS

Reproduced from or based upon 2010 Ordnance Survey mapping with permission of the Controller of HMSO (c) Crown Copyright reserved.  
Unauthorised reproduction infringes Crown copyright and may lead to prosecution or civil proceedings West Sussex County Council Licence No. 100018485

TILE REF NO:  
TQ2105NES

SHEET ISSUE NO 3  
SHEET ACTIVE FROM - 01/05/2014



SCALE:  
1:1250  
at A3 size

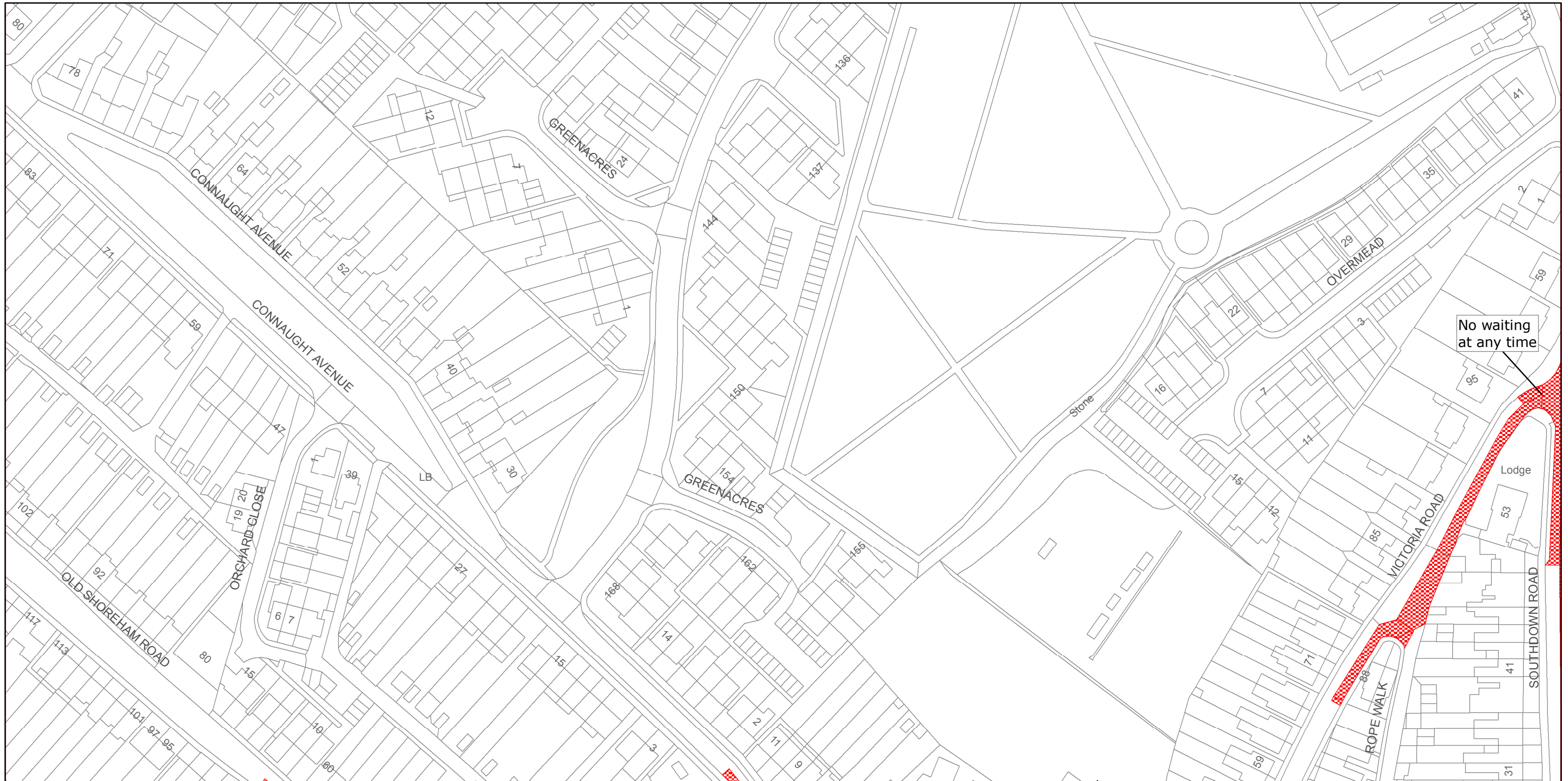

No waiting  
at any time



West Sussex County Council  
Highways & Transport  
The Grange  
Tower Street  
Chichester  
West Sussex  
PO19 1RH

ADUR DISTRICT: SHOREHAM/SOUTHWICK  
  
WAITING RESTRICTIONS

Reproduced from or based upon 2010 Ordnance Survey mapping with permission of the Controller of HMSO (c) Crown Copyright reserved.  
Unauthorised reproduction infringes Crown copyright and may lead to prosecution or civil proceedings West Sussex County Council Licence No. 100018485

TILE REF NO:  
**TQ2105NWS**

SHEET ISSUE NO 2  
SHEET ACTIVE FROM - 01/05/2014



SCALE:  
1:1250  
at A3 size



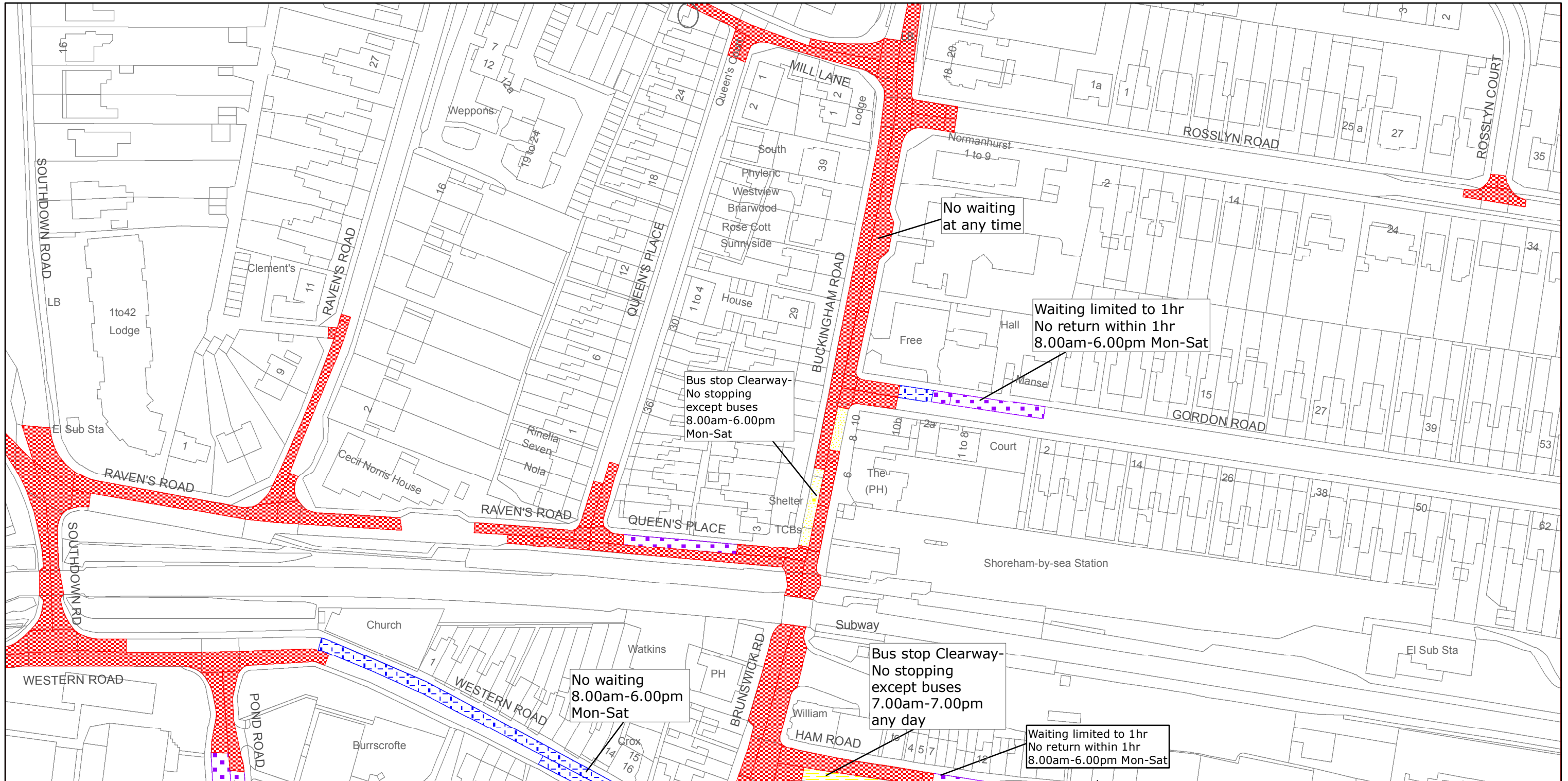

West Sussex County Council  
Highways & Transport  
The Grange  
Tower Street  
Chichester  
West Sussex  
PO19 1RH

ADUR DISTRICT: SHOREHAM/SOUTHWICK  
WAITING RESTRICTIONS

Reproduced from or based upon 2010 Ordnance Survey mapping with permission of the Controller of HMSO (c) Crown Copyright reserved.  
Unauthorised reproduction infringes Crown copyright and may lead to prosecution or civil proceedings West Sussex County Council Licence No. 100018485

TILE REF NO:  
TQ2105SEN

SHEET ISSUE NO 4  
SHEET ACTIVE FROM - 01/05/2014



SCALE:  
1:1250  
at A3 size

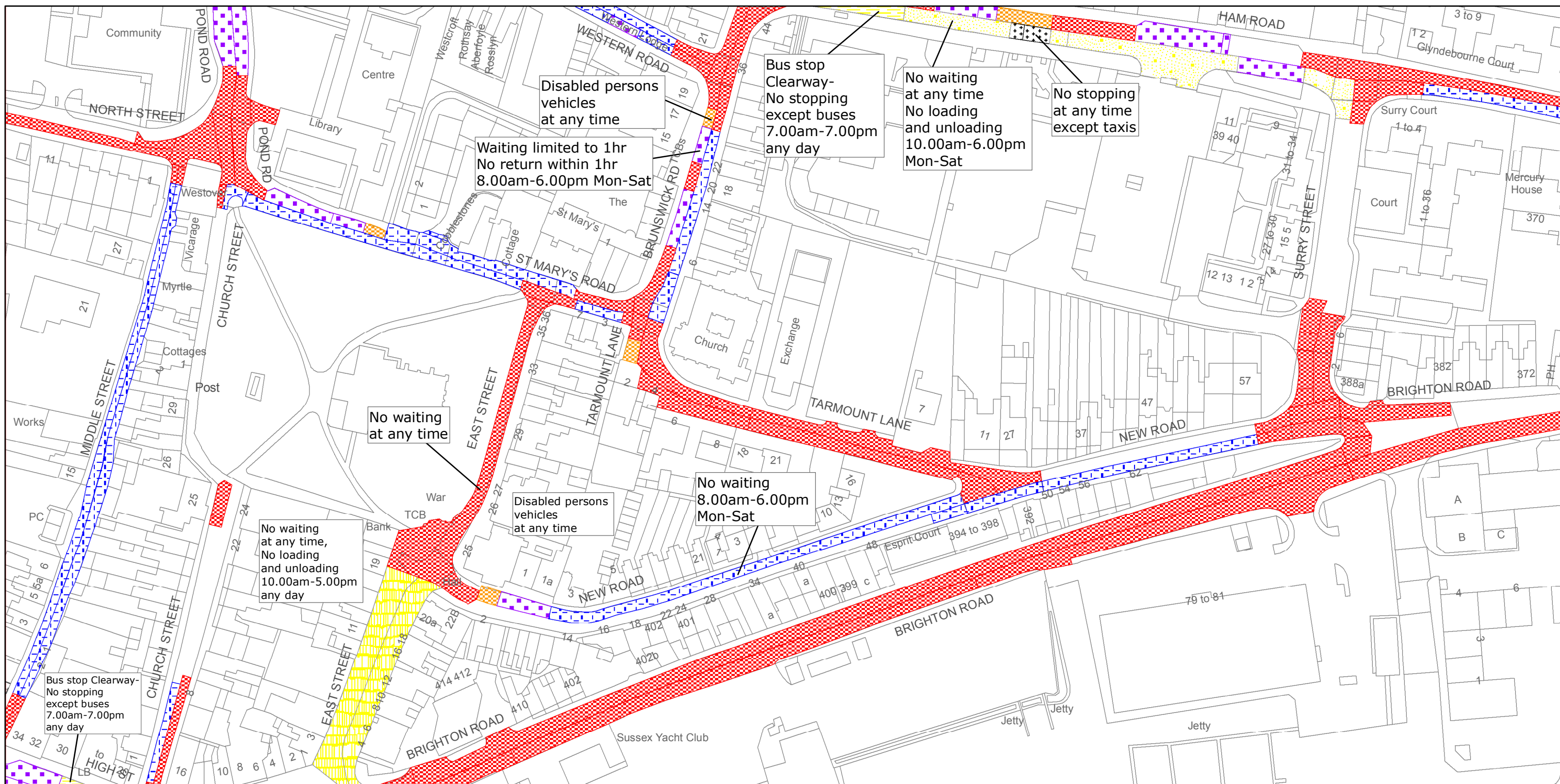

West Sussex County Council  
Highways & Transport  
The Grange  
Tower Street  
Chichester  
West Sussex  
PO19 1RH

ADUR DISTRICT: SHOREHAM/SOUTHWICK  
WAITING RESTRICTIONS

Reproduced from or based upon 2010 Ordnance Survey mapping with permission of the Controller of HMSO (c) Crown Copyright reserved.  
Unauthorised reproduction infringes Crown copyright and may lead to prosecution or civil proceedings West Sussex County Council Licence No. 100018485

TILE REF NO:  
TQ2105SES

SHEET ISSUE NO 5  
SHEET ACTIVE FROM - 01/05/2014



SCALE:  
1:1250  
at A3 size



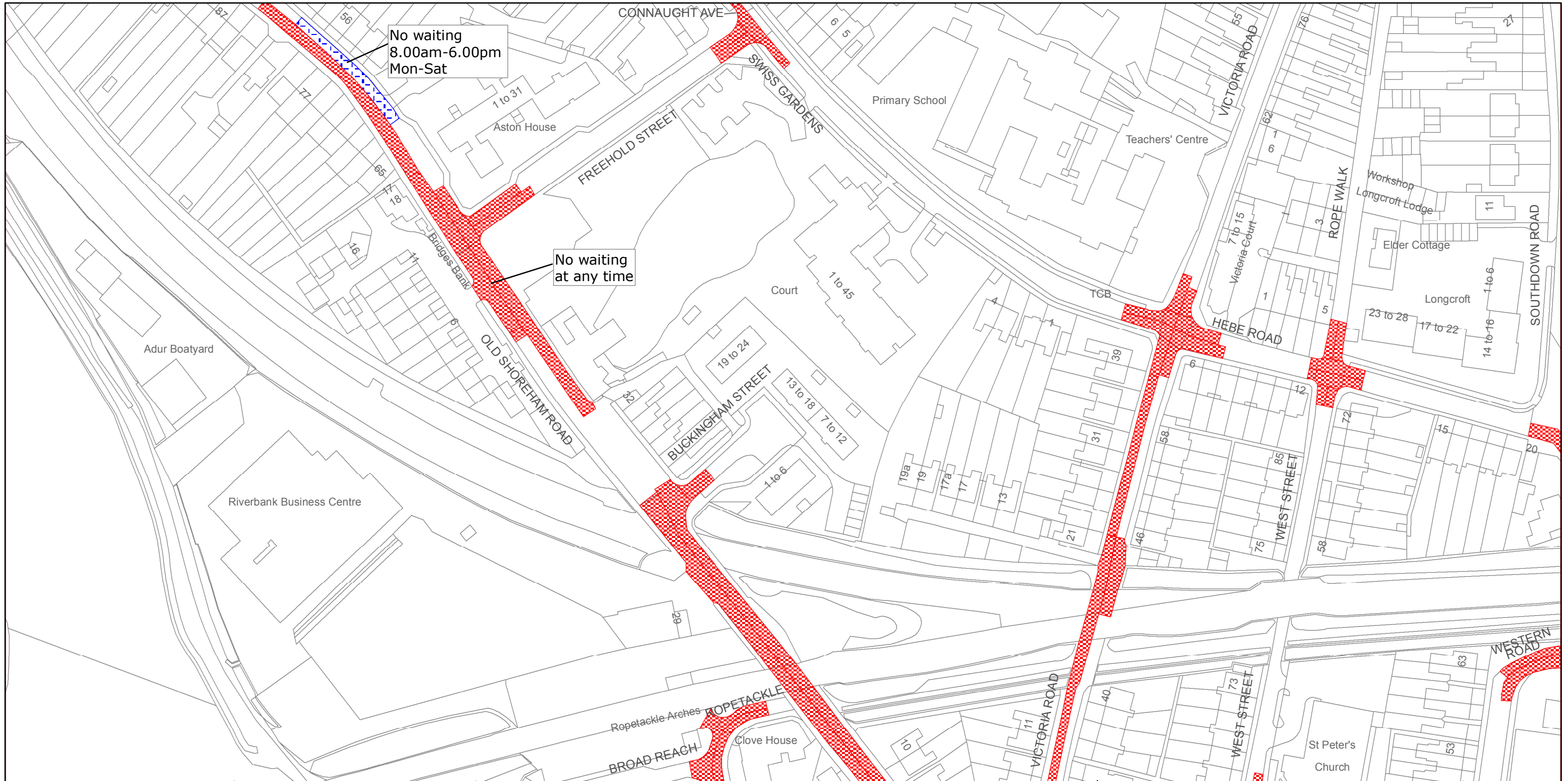

West Sussex County Council  
Highways & Transport  
The Grange  
Tower Street  
Chichester  
West Sussex  
PO19 1RH

ADUR DISTRICT: SHOREHAM/SOUTHWICK  
WAITING RESTRICTIONS

Reproduced from or based upon 2010 Ordnance Survey mapping with permission of the Controller of HMSO (c) Crown Copyright reserved.  
Unauthorised reproduction infringes Crown copyright and may lead to prosecution or civil proceedings West Sussex County Council Licence No. 100018485

TILE REF NO:  
TQ2105SWN

SHEET ISSUE NO 3  
SHEET ACTIVE FROM - 01/05/2014



SCALE:  
1:1250  
at A3 size



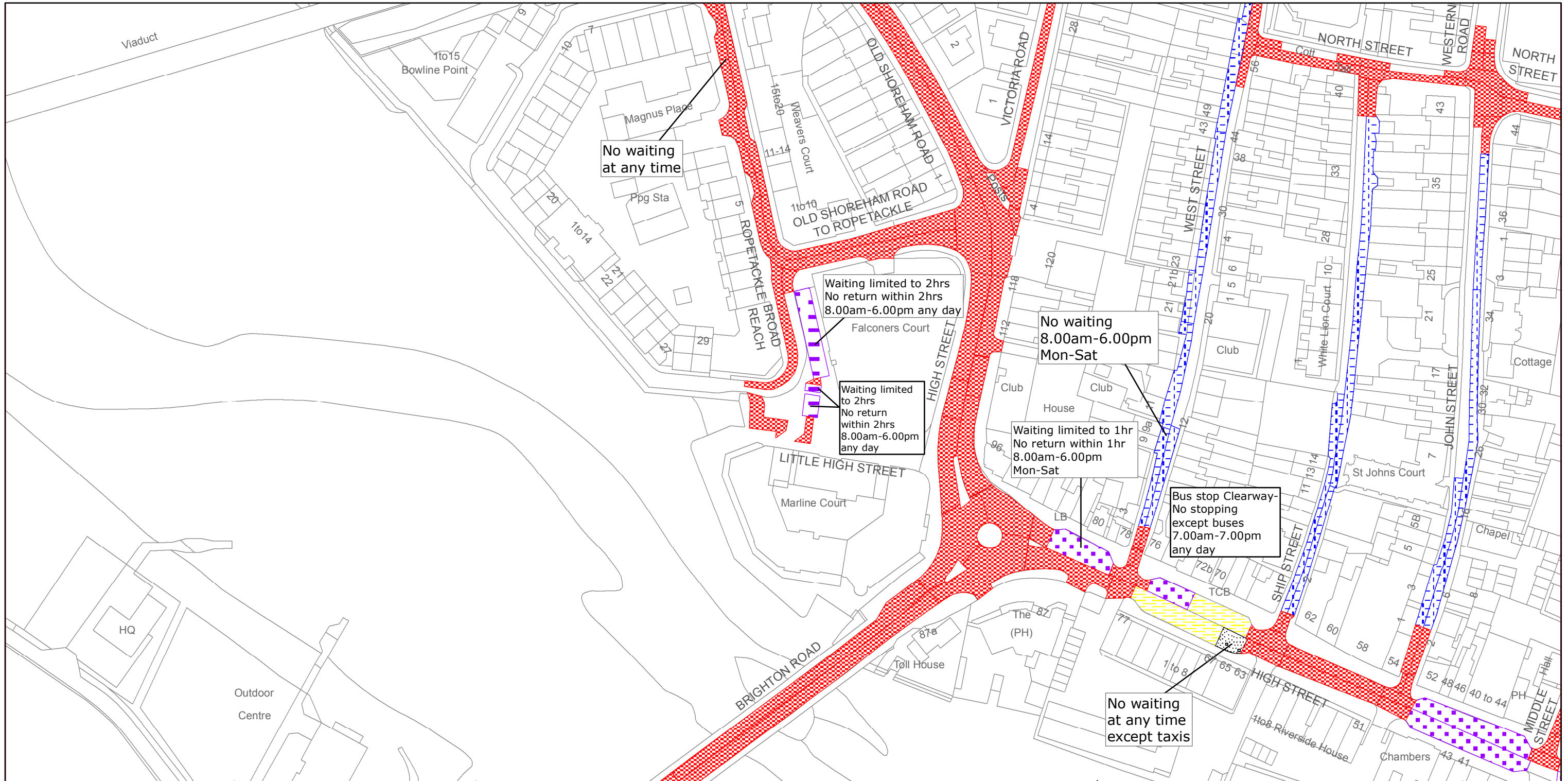

West Sussex County Council  
 Highways & Transport  
 The Grange  
 Tower Street  
 Chichester  
 West Sussex  
 PO19 1RH

# ADUR DISTRICT: SHOREHAM/SOUTHWICK

## WAITING RESTRICTIONS

Reproduced from or based upon 2010 Ordnance Survey mapping with permission of the Controller of HMSO (c) Crown Copyright reserved.  
 Unauthorised reproduction infringes Crown copyright and may lead to prosecution or civil proceedings West Sussex County Council Licence No. 100018485

# TILE REF NO: TQ2105SWS

SHEET ISSUE NO 3  
 SHEET ACTIVE FROM - 01/05/2014



SCALE:  
 1:1250  
 at A3 size

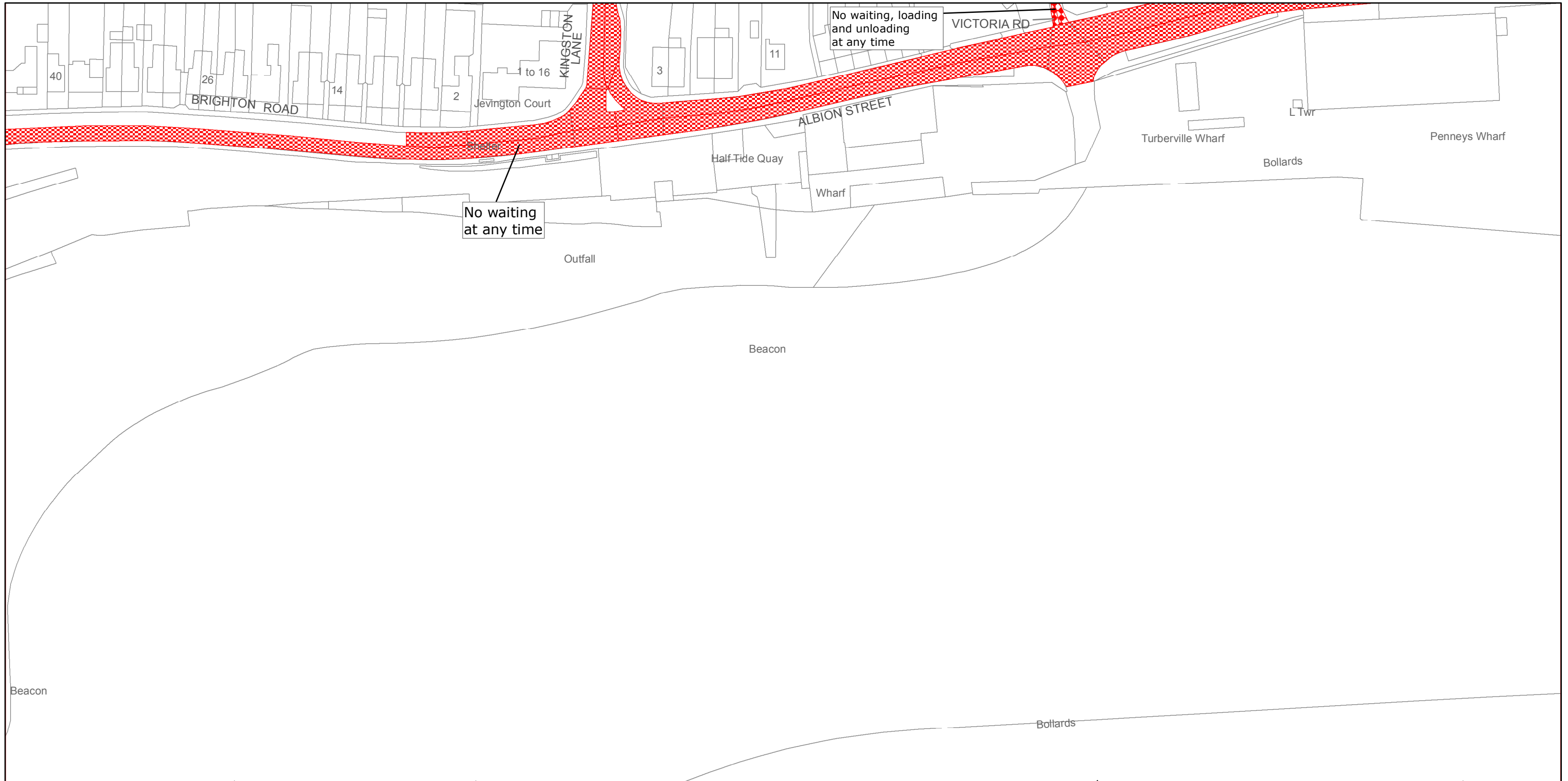

West Sussex County Council  
Highways & Transport  
The Grange  
Tower Street  
Chichester  
West Sussex  
PO19 1RH

ADUR DISTRICT: SHOREHAM/SOUTHWICK

WAITING RESTRICTIONS

Reproduced from or based upon 2010 Ordnance Survey mapping with permission of the Controller of HMSO (c) Crown Copyright reserved.  
Unauthorised reproduction infringes Crown copyright and may lead to prosecution or civil proceedings West Sussex County Council Licence No. 100018485

TILE REF NO:  
TQ2304NEN

SHEET ISSUE NO 2  
SHEET ACTIVE FROM - 01/05/2014



SCALE:  
1:1250  
at A3 size

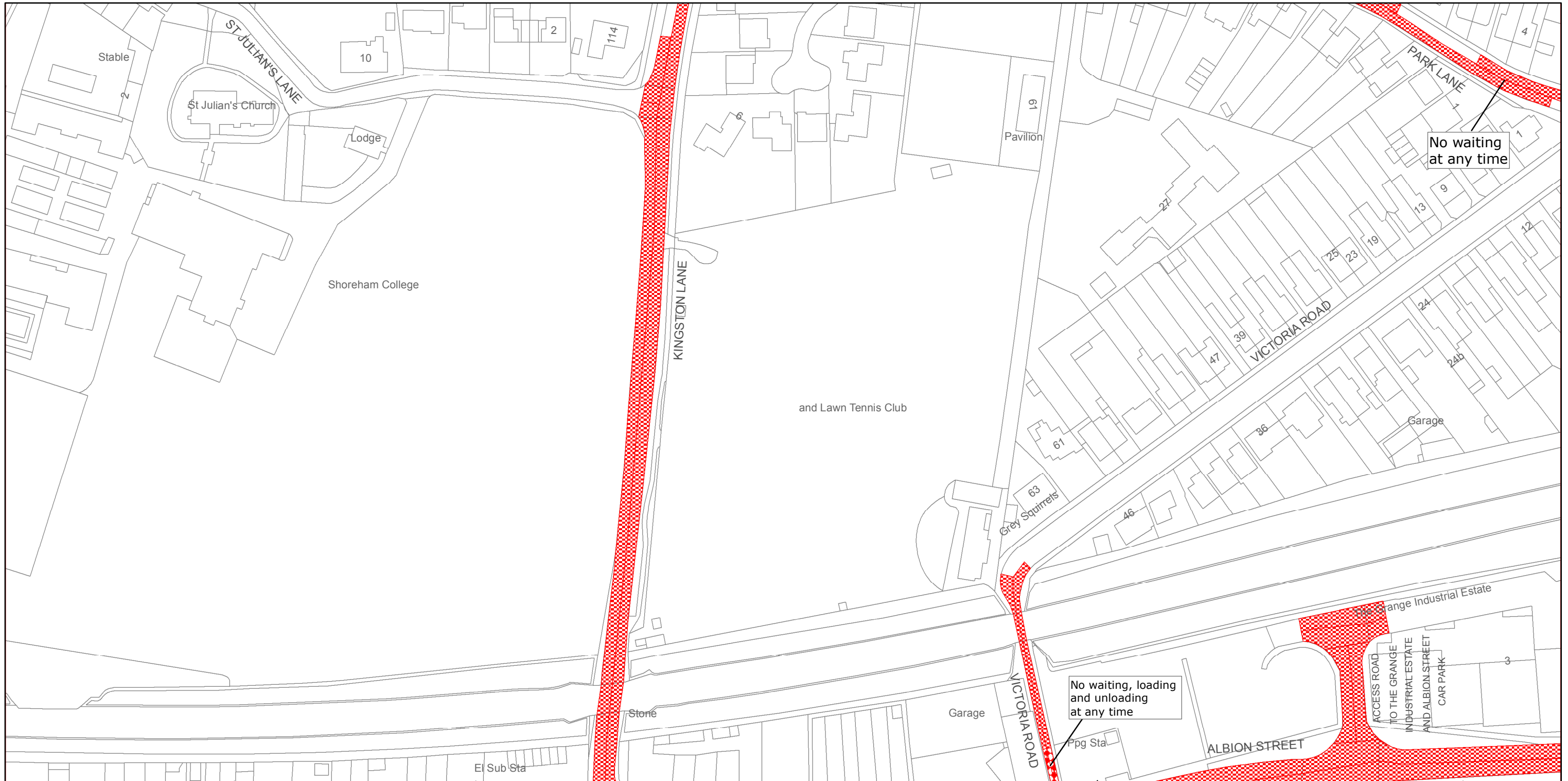

West Sussex County Council  
Highways & Transport  
The Grange  
Tower Street  
Chichester  
West Sussex  
PO19 1RH

ADUR DISTRICT: SHOREHAM/SOUTHWICK  
WAITING RESTRICTIONS

Reproduced from or based upon 2010 Ordnance Survey mapping with permission of the Controller of HMSO (c) Crown Copyright reserved.  
Unauthorised reproduction infringes Crown copyright and may lead to prosecution or civil proceedings West Sussex County Council Licence No. 100018485

TILE REF NO:  
TQ2305SES

SHEET ISSUE NO 2  
SHEET ACTIVE FROM - 01/05/2014



SCALE:  
1:1250  
at A3 size